

## auto electrical parts

### Technical Information Sheet

**Part No. 0-008-30**

Heavy Duty Butt Splice Connector

Durite's Heavy Duty Butt Splice Connector. Used to connect or splice two wires to lengthen, change or repair an electrical circuit. Suitable for Automotive, Marine, Commercial and Industrial Applications.

Size: 16mm<sup>2</sup>

Material: Tin Plated Copper



Technical Drawing (not to scale)

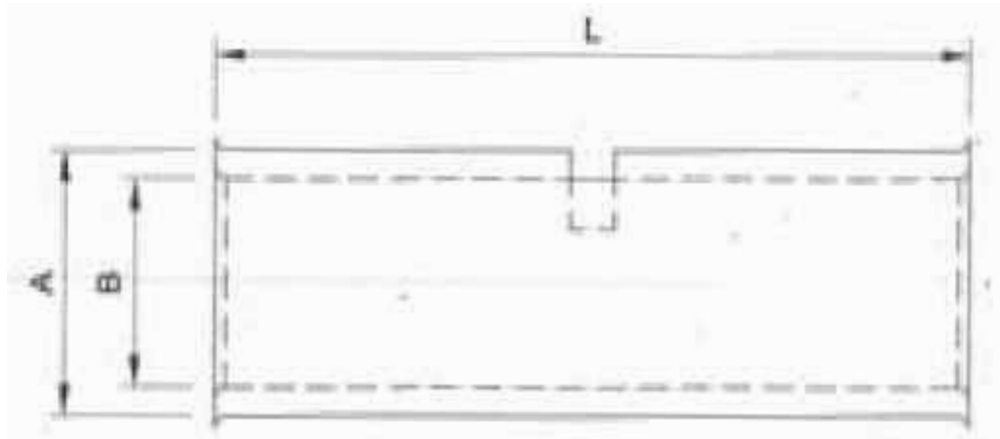

### Specification

Size:	16mm <sup>2</sup>
Material:	Tin Plated Copper
Colour:	Silver
Certificate:	n/a
Dimensions:	OD: 7.0mm. ID: 5.6mm <sup>2</sup> . L: 30mm

The information contained in this document is correct to the best of our knowledge at the time of printing. However, specifications may change at any time without notice.

### **Gordon Equipments Limited**

Durite Works  
Valley Road  
Dovercourt  
Essex CO12 4RX  
England



Tel: +44 (0)1255 555200  
Fax: +44 (0)1255 555222  
E-mail: [sales@durite.co.uk](mailto:sales@durite.co.uk)  
Web: [www.durite.co.uk](http://www.durite.co.uk)

Registered in England at address shown No. 373113  
The words 'Gordon', 'Durite', 'Nolten' and 'Acfil' are registered trade marks